

CFM-21S Series

20 Watt Single Output with Options for
PCB mount (Blank)
Connector (-T)
Screw Terminal (-S)
Encapsulated (-E)



Features

Universal Input Range 90-264VAC
 Miniature Size, Low Profile 0.8"
 Industry-Standard Pin Out
 Efficiency to 85%
 Continuous Short Circuit Protection
 Over Voltage Protection
 No load input power < 0.3W
 Leakage Current < 0.1mA



UL60601-1/IEC60601-1/EN60601-1 Medical safety
 Meets UL60950-1/IEC60950-1/EN60950-1 ITE safety
 EN55022 Class "B" and CISPR/FCC Class B, Conducted
 EN55024



Model	Output voltage	Max. load	Min. load	Ripple & Noise	Voltage accuracy	Line regulation	Load regulation	Efficiency (Typ.)
CFM-21S033	3.3V	4.0A	0A	50mV	±1%	±0.5%	±1%	75 %
CFM-21S050	5V	4.0A	0A	50mV	±1%	±0.5%	±1%	80 %
CFM-21S090	9V	2.3A	0A	90mV	±1%	±0.5%	±1%	81 %
CFM-21S120	12V	1.7A	0A	100mV	±1%	±0.5%	±1%	83 %
CFM-21S150	15V	1.4A	0A	100mV	±1%	±0.5%	±1%	84 %
CFM-21S240	24V	0.9A	0A	100mV	±1%	±0.5%	±1%	85 %

SPECIFICATIONS

Typical at 25°C, nominal line and 75% load, unless otherwise Specified

Input Specifications:

Maximum input voltage range AC 80 – 264Vac
 Maximum input voltage range DC 115 – 370Vdc
 Frequency 47 to 63Hz
 Maximum Input current at 100Vac 0.5A
 Inrush Current 40A max. @240Vac
 Isolation Input to output = 5'656 Vdc
 Conducted EMI CISPR/FCC Class B
 Leakage Current 0.1mA max.

Weight Blank: ... 50gr
 -T: ... 55gr
 -S: ... 55gr
 -E: . 105gr

Safety:

..... Class II
 IEC 60601-1:2006+A1:2013+A12:2014+A2:2021

Output Specifications:

Voltage accuracy ±1%
 Holdup Time 10mS typ. @115Vac
 Line Regulation⁽³⁾ ±0.5%
 Load Regulation⁽⁴⁾ ±1%
 Short Circuit Protection Continuous
 Over Voltage Protection TVS Component to Clamp
 Temperature Coefficient ±0.05%/°C

EMC:

..... EN55032, Class B
 CISPR11 2015+A1: 2016+A2:2021, Class B
 EN IEC 61000-3-2:2018
 EN IEC 61000-3-3:2013+A1:2017

General Specifications: Note:

Isolation input to output..... 5'656Vdc
 Operating Temperature, see derating -25 ~ 70°C
 Storage Temperature -40 ~ 85°C
 Cooling Natural Convection
 Switching Frequency 100KHz Typical
 Humidity 0~93% at 25°C
 MTBF MIL-STD-217F, GB 650K hrs min

Note:

1. Voltage accuracy is set of 100% rated load.
2. Add a 0.1uF ceramic capacitor and a 10uF capacitor to output for Ripple & Noise measuring @20MHz BW.
3. Line regulation is measured from 100Vac to 240Vac with full load.
4. Load regulation is measured from 10% to 100% full load.
5. T Version Connection: JST B3P-VH / B4P-VH or equivalent.
6. S Version Connectors : DECA MB332-381A or equivalent.

Mechanical Characteristics:

Dimensions Blank: 60.5 x 40.6 x 20.4mm
 -T: ... 76.2 x 40.6 x 19.5mm
 -S: ... 76.2 x 40.6 x 19.5mm
 -E: ... 64.2 x 44.2 x 20.4mm

CFM-21S Series Derating Curve

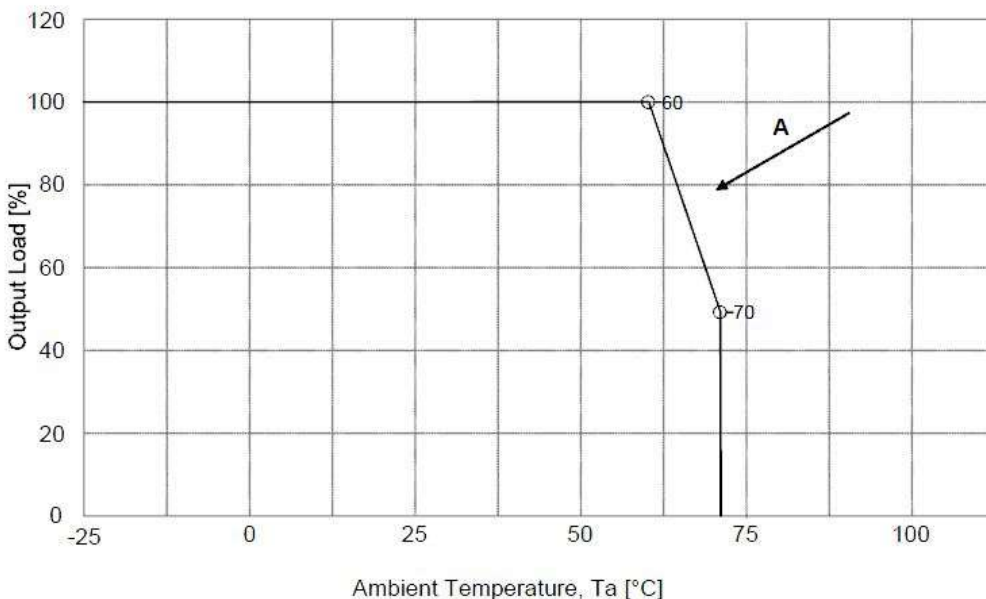

A : Natural Convection 0.1m/s

CFM-21S Series Drawings

All Dimensions in mm

Option Blank

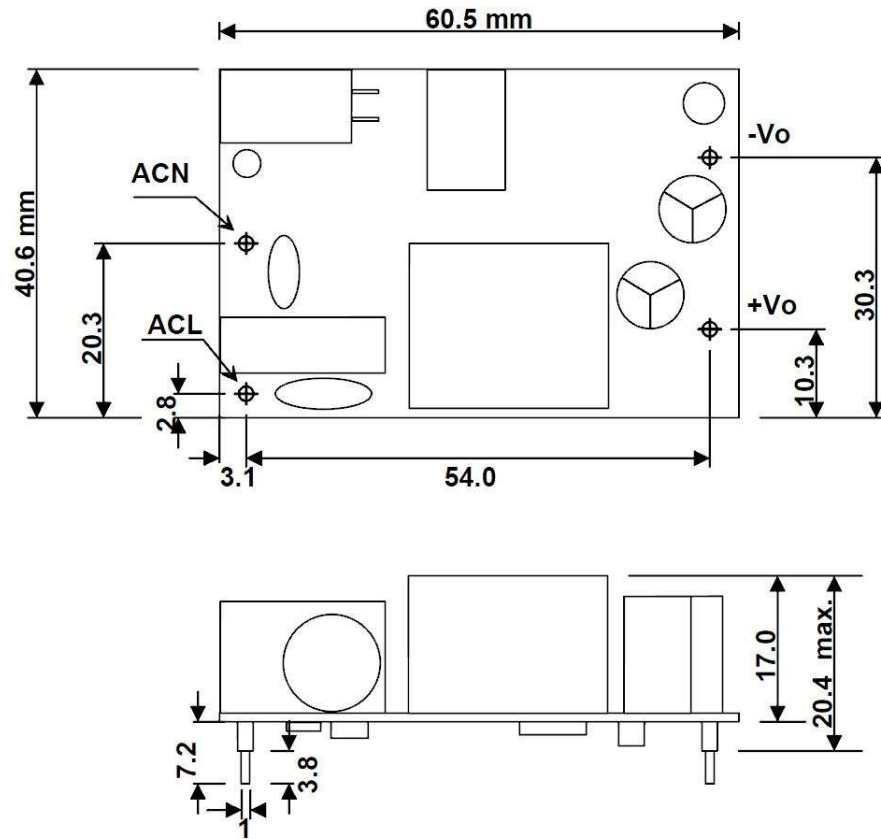

Option -T

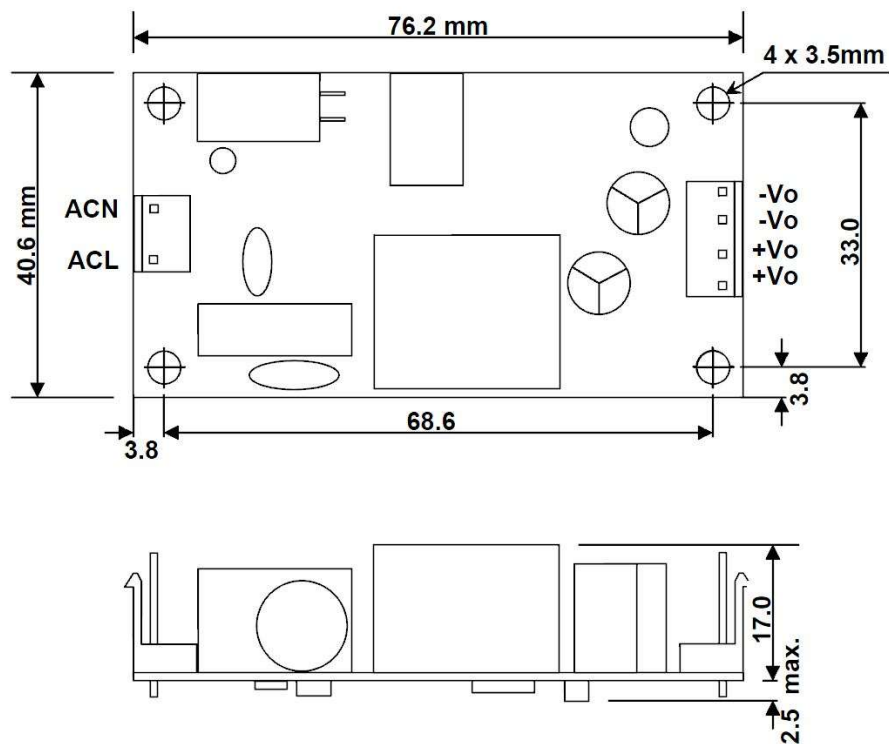

CFM-21S Series Drawings

Option -S

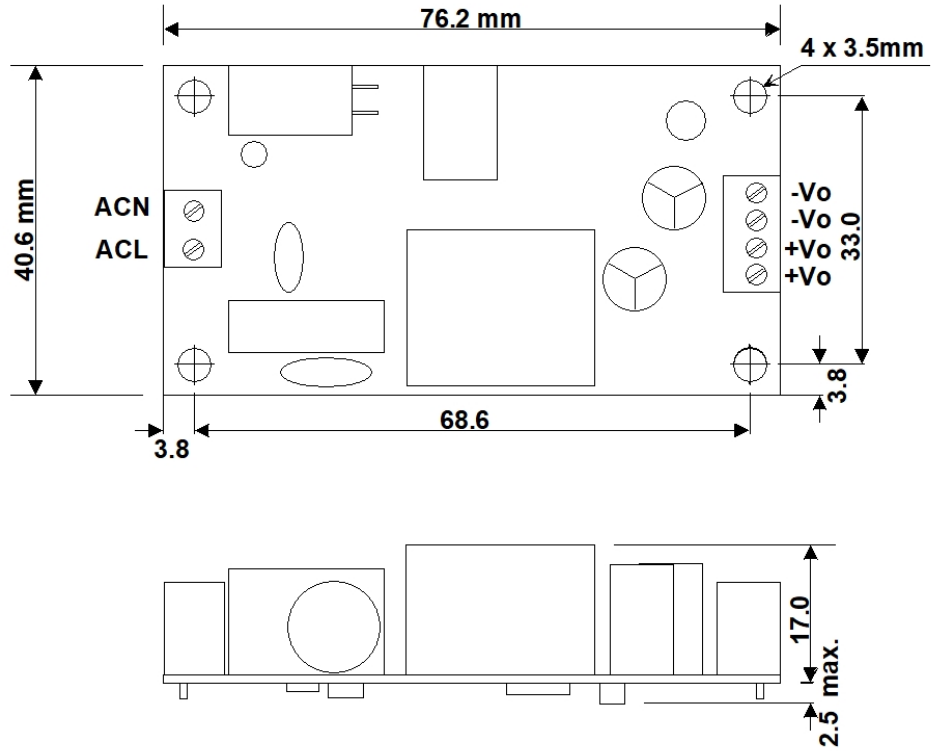

Option -E

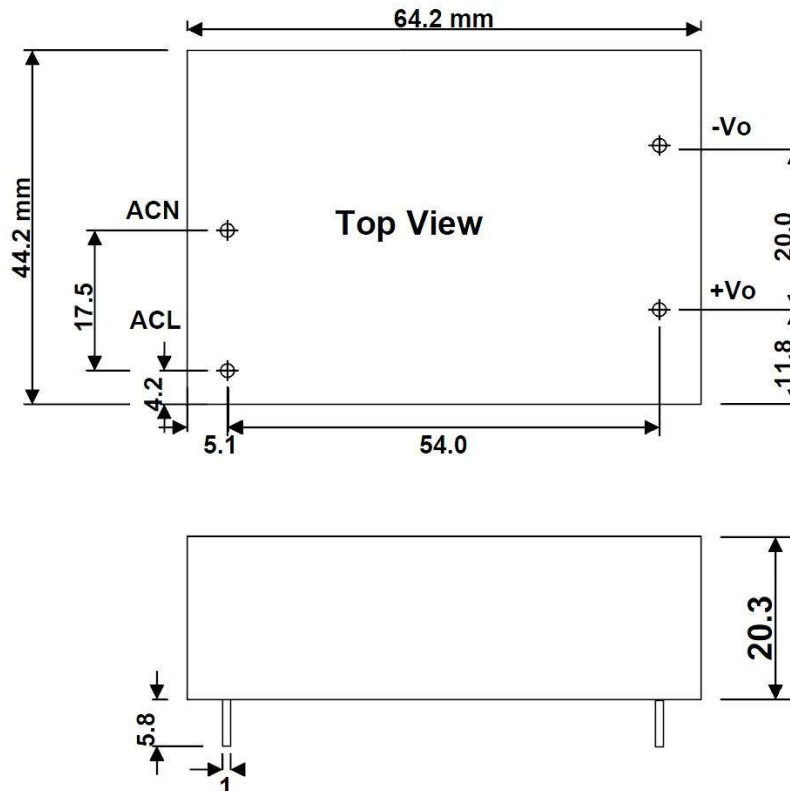

Notice: All statements, technical information, and recommendations related to FABRIMEX's products are based on information believed to be reliable, but the accuracy or completeness thereof is not guaranteed. Before utilizing the product, the user should determine the suitability of the product for its intended use. Specifications can be changed any time without notice.

Switzerland:
 Exista AG - Mettlenbachstrasse 23
 CH-8617 Mönchaltorf
 Tel: +41 55 253 31 90
www.fabrimex.com / www.exista.ch
info@fabrimex.ch

International:
 Please see our distributors
www.fabrimex.com/contact/distribution.html

EXISTA